

HOLE 80 I 007
COORDINATES 36°60N, 00°46.5W
COLLAR ELEVATION 1144 m
AZIMUTH 095 DIP -50
DEPTH 83.94 (277')

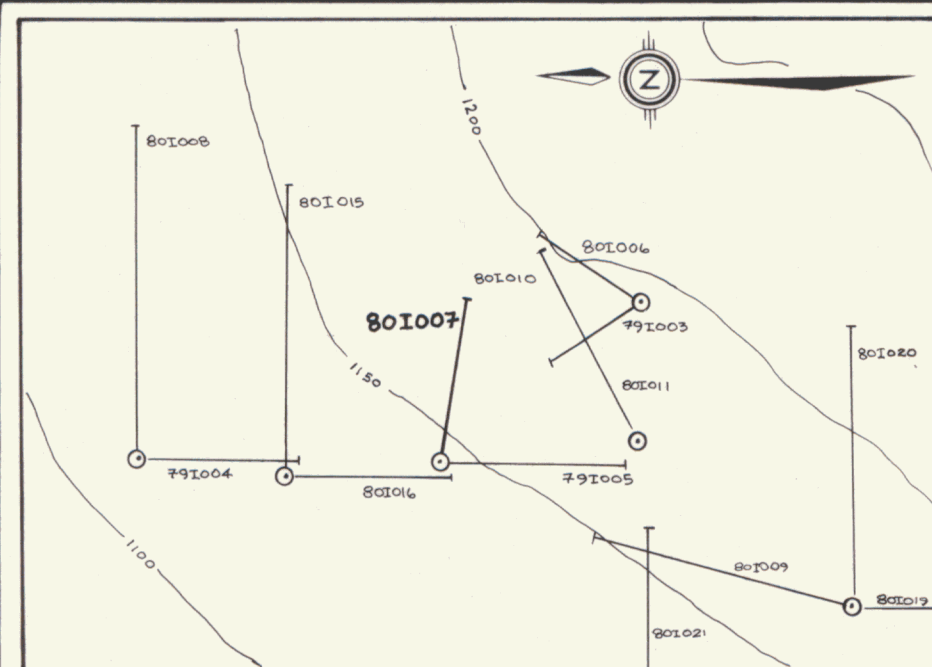

LOCATION MAP SCALE 1:2500



LEGEND

- HELIKIAN**
- Iron-Rich Breccia (HB-4): high but variable concentrations of euhedral to massive magnetite (hematite with associated barite, pyrite, chlorapatite & carbonates, both in matrix & replacing breccia fragments)
 - Chloritic Breccia (HB-3): dark green chloritic matrix & fragments often hematitic, associated with HB-4 & fault zones
 - Red-Brown Breccia (HB-1): hematitic breccia with carbonate, chlorite & hematite matrix containing altered, subround to fragments, pink to red-brown > grey to light green fragments. Breccia varies from matrix to fragment supported. Rarely faulted.
 - Light Green Breccia (HB-2): strongly foliated, silvery-grey to red-brown weathering breccia consisting of light green to pink phyllites, white to pink quartzite & thin to thick phyllite fragments in a pink to red-brown matrix. Breccia is always fragment supported. Weathers recessively compared to HB-1.
- HELIKIAN?**
- Quarter Group (Hs): grey to black shale, siltstone & phyllite interbedded with quartzites & siltstones exhibiting turbidite structures
- ALTERED QUARTER GROUP (Hs):** bleached, hematized & carbonized equivalent of Hs, pale green phyllites, brown weathering grey siltstones and white-pink quartzites, occasionally limy
- FAULT**
- ppm U
 - ppm Cu
 - ppm Co

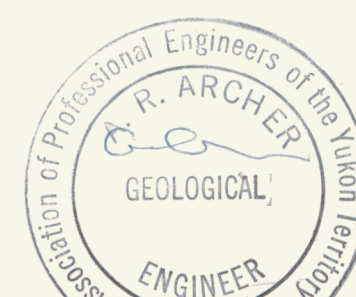

FIGURE WSV 80-I-30
 ARCHER, CATHRO & ASSOCIATES LTD

SECTION HOLE 80I007

IGOR PROPERTY

090756

WERNECKE JOINT VENTURE

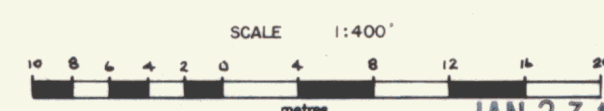

JAN 23 1981

To accompany report dated 1980-10-10